

# Setting up a 'Hot-Key' for Action Station

<http://www.1clickactions.com>

These instructions supersede those referring to a 'Hot-Key' action. If you have already set up an action to launch Action Station it is recommended that you delete it and use this method instead.

In certain circumstances launching Action Station from a hot-key assigned to an action can cause an issue if the action run from within Action Station contains interactive stops.

There is no need to remove or reinstall Action Station.

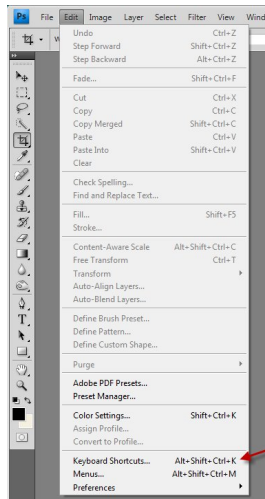

Select Edit->Keyboard Shortcuts from the Photoshop menu.

On Windows you can use Alt-Shift-Ctrl-K

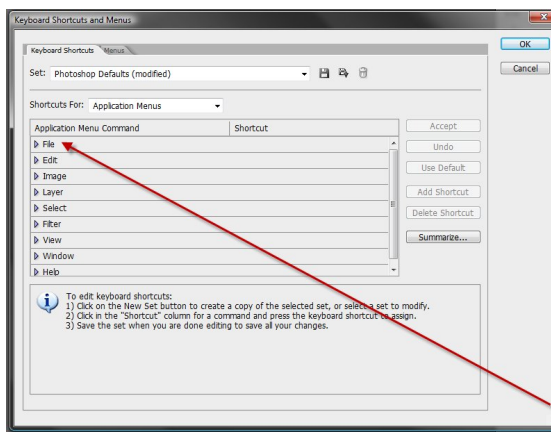

Click the File option and navigate to the Scripts section.

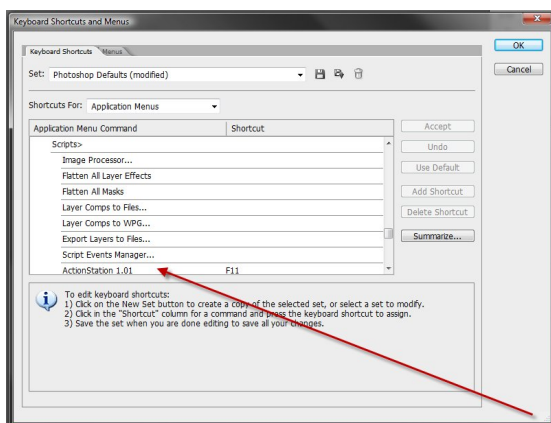

Select the entry for Action Station and set the Short-Cut (or HotKey).

In the screen shot F11 has been assigned.

You can then close the dialog and launch Action Station from the F11 key.