

BEFORE YOU RUN THE ACTION

1. Preparing your photo document:

- a. Check the layer panel and make sure your photo has only a single **background layer** (see the picture below). To set your photo as a background: Go to **menu bar**, then select **Layer > Flatten Image**.



The "**Background**" layer probably will have a different name if you use non-English Photoshop version - That's fine, just keep it as it is.

- b. Your photo must in **RGB color mode**. To set the color mode: Go to menu bar, then select **Image > Mode > RGB Color**
- c. Your photo must have **8 bits color**. To set the color bit: Go to menu bar, then select **Image > Mode > 8 Bits/Channel**.
- d. Make sure the photo resolution is **72dpi or higher**.

2. Prepare your Photoshop:

- a. Make sure the "Add 'copy'..." option is selected.

To do this:

- i. Go to layer panel and open the option menu (click the dropdown icon on the top right corner of the Layer Panel).
- ii. When the menu is already open, click on "**Panel Option**" to open the Layers Panel Options.
- iii. Next, select (checked) the "**Add 'copy' to Copied Layers and Groups**" (see the picture below)

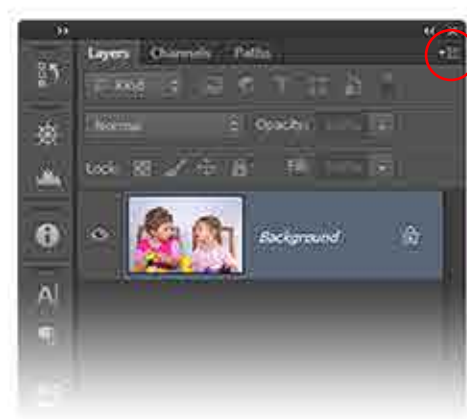

← Click this flayout menu

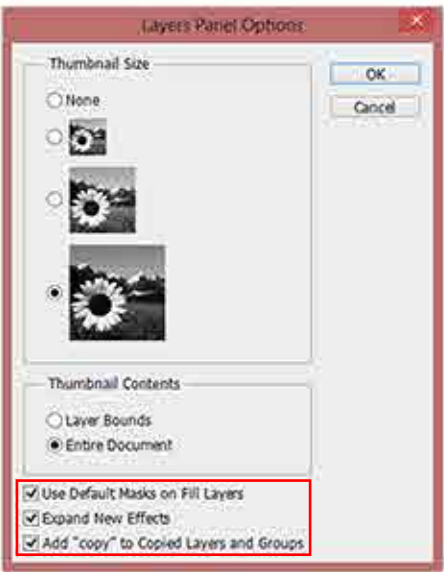

Make sure to select this options →

