

TV Pop-Out Creator

By Jipito

1. Extract the zip file into your work folder. This will create the ***TV Pop-Out Creator*** sub folder containing this documentation file, the startup PSD files and the main Photoshop Action (.atn) file.
2. Either double click on the ATN file or use the actions panel in Photoshop to load the action set.
3. There are 5 actions, one for each TV position, 1 x Front view, 2 x Right views & 2 x Left views.
4. First open the corresponding startup file in Photoshop (Front View.psd, Pop Out to Left.psd or Pop Out to Right.psd).
5. Choose & play the action.
6. When prompted load the photo you want to use, resize it to fit the screen and press ***Return*** on your keyboard to place it.



7. You will then see the following message...

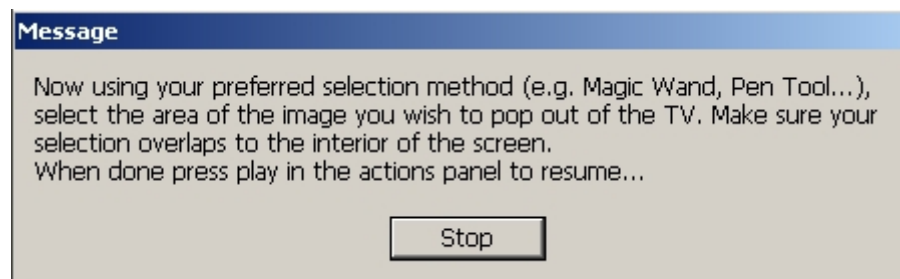



8. Carefully select the section of the image that you want to pop out of the TV, then press **Play** in the actions panel to continue with the rest of the sequence.

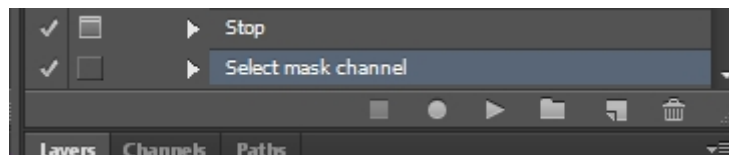

9. Voila! Now you can admire the result!



Note: Different photos are suited to different actions. For example a picture of an aeroplane flying to the right would suit *Action 2 – Pop Out to Right*.or *Action 3 – Pop Out to Right 2*.

OK, that's it. Thanks for purchasing and please don't forget to rate this item on graphicriver.net if you like it!

Also check out my other add-ons on Graphicriver