

3D Extrude-Carve Actions

By Jipito

1. Extract the zip file into your work folder. This will create the **3D Extrude-Carve Actions** sub folder containing this documentation file, and the main Photoshop Action (.atn) file.
2. Either double click on the ATN file or use the actions panel in Photoshop to load the action set.
3. There are 21 actions, one for each 3D view and depth (3 to choose from).
4. Select & play an action. You don't need to start off with an open PSD file because the action automatically does this for you.

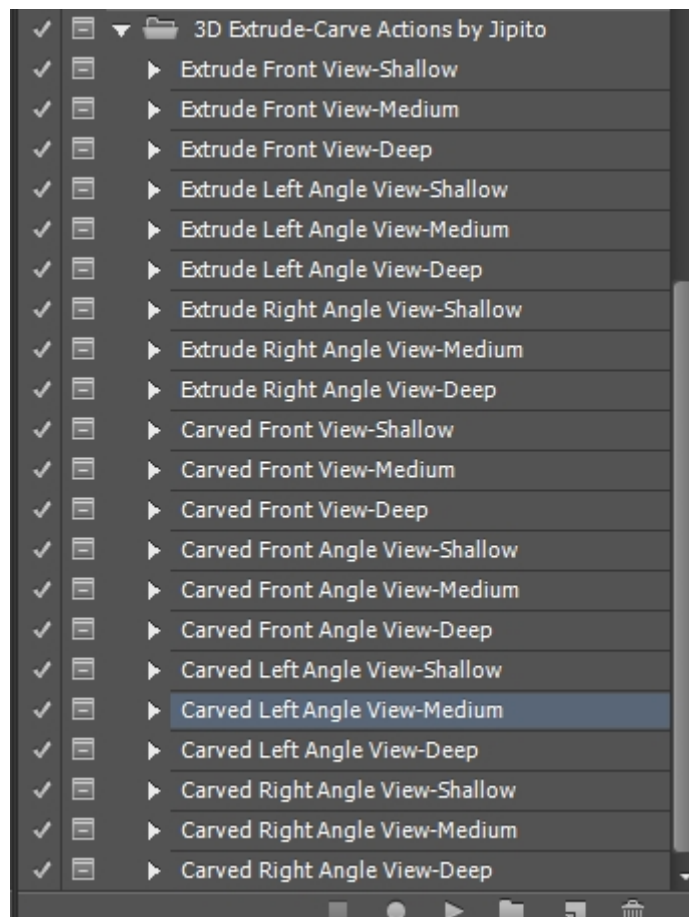

Choose an action

5. When prompted enter or paste in your design or text, trying to occupy as much of the screen as possible, then press **Play** in the actions panel to run the rest of the action.

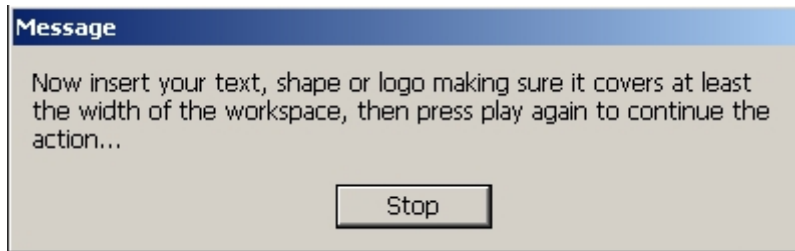

Enter text and/or logo



Enjoy the result!

6. In the **Layers** panel you will see that there are two colour adjustment layers, (marked in yellow), that are hidden by default. If you wish to use them just make them visible by clicking on the eye icons and double click on each colour thumbnail to open the colour picker.

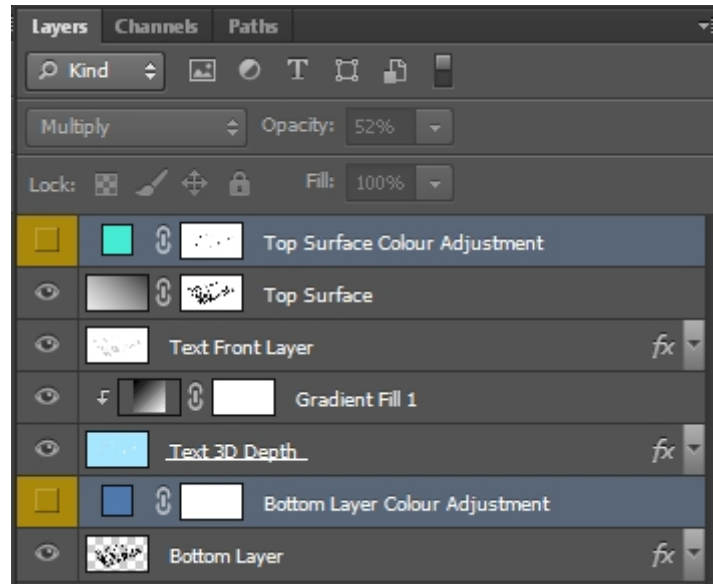

Coloured result

7. Voila! Now you can admire the result!

OK, that's it. Thanks for purchasing and please don't forget to rate this item on graphicriver.net if you like it!

Also check out my other add-ons on Graphicriver